

ARE YOU DEAF/BSL USER?

Is your house design and layout
good for Deaf people to live in?

If not, we're filming a new home improvement
TV show, making houses more accessible
for Deaf people.

Interested - or know someone who might be?

Email us now:

takepart@drummertelevision.com

BSL VIDEO? PLEASE CLICK HERE:

bit.ly/drummerhomeowners

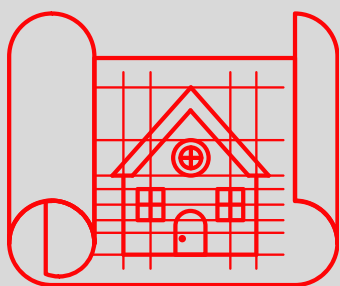

drummer**tv**